

HD1 broadcast unit with 12-24 cameras

Use: sport broadcasts, shows, music and theatre productions

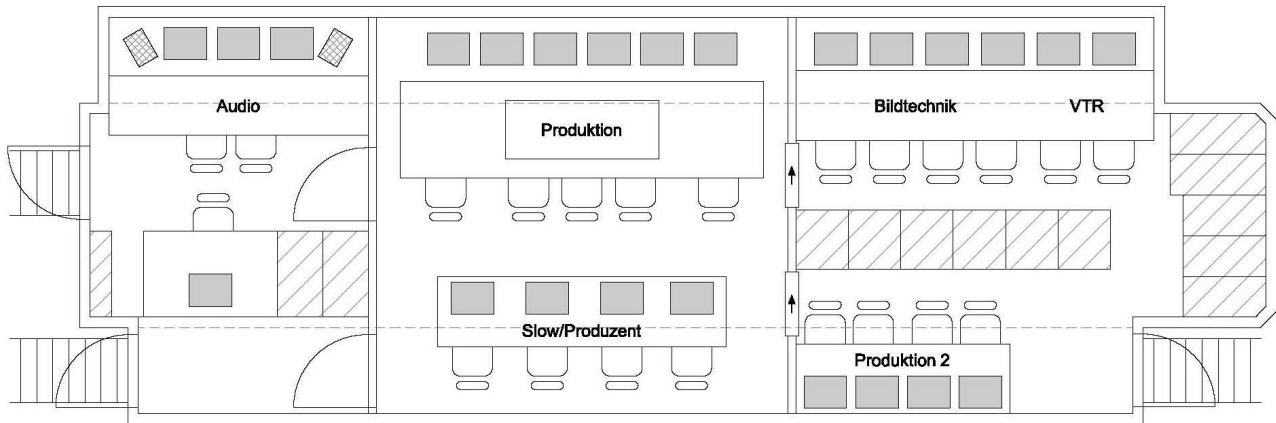



Video

- Multiformat switchable HDTV/SDTV with up to 24 high-end cameras
- Main mixer: 1 Sony MVS-8000 (51 inputs/48 outputs/4 mixing units)
- Pre-mixer: 1 Sony MKS-9012
- Matrix: 1 Probel HD/SD 320 x 416
- Control system: BFE
- Director monitoring: PGM and PST Sony BVM-A24E CRT Preview max. 64 (16 x quadsplit)
- Text generator: 1 Vizrt HD

Cameras

- 12-24 Sony HDC-1500
- Lenses/tripods as desired

Recording/slow motion

HDTV/SDTV recording

Basic equipment:

- 2 EVS live/slow motion (6 channels)
- 4 HDCAM SR
- 2 XDCAM Sony PDW-HD1500
- 4 Digi-Beta
- 2 IMX
- 6 DVD



Audio

- Stereo/Surround Sound (5.1)
- STAGETEC audio system (Nexus/Aurus) 48 operations (max. 288 audio channels)
- Dolby E
- Yamaha DM series averager/submixer
- Various effects devices: TC System 6000/Lexicon 960L/Lexicon 96 TC System DB8 (2x Surround Sound & stereo)
- Pyramix/Ovation Audio Workstation 48-96 channel recording 5 simultaneous playouts (5.1) Audio editing/processing
- 6 Delec commentator units (expandable to 12)
- Various wireless microphone/ in-ear systems
- Audio monitoring 5.1: Tannoy



Communication

- Tellix communication system: stations with selective speed and numerical dialing
- Various ISDN codecs, telephone hybrids
- Wireless intercom system for production manager/sound/equipment
- Network for control, video, audio, communication and additional services

Vehicle

Semi-trailer with active steering for rear axles

- Length 16.5m
- Width 2.5m / 4.6 m
- Height 4.0m
- Weight 39 t
- Power connection 2 x CEE 63

technology and production center switzerland ag

Fernsehstrasse 1-4 | CH-8052 Zürich, Switzerland

Phone +41 44 305 40 00 | Fax +41 44 305 40 10

www.tpc.ch